

SUMPGUARD

VERTICAL PUMPS

 **LAKESIDE
EQUIPMENT**

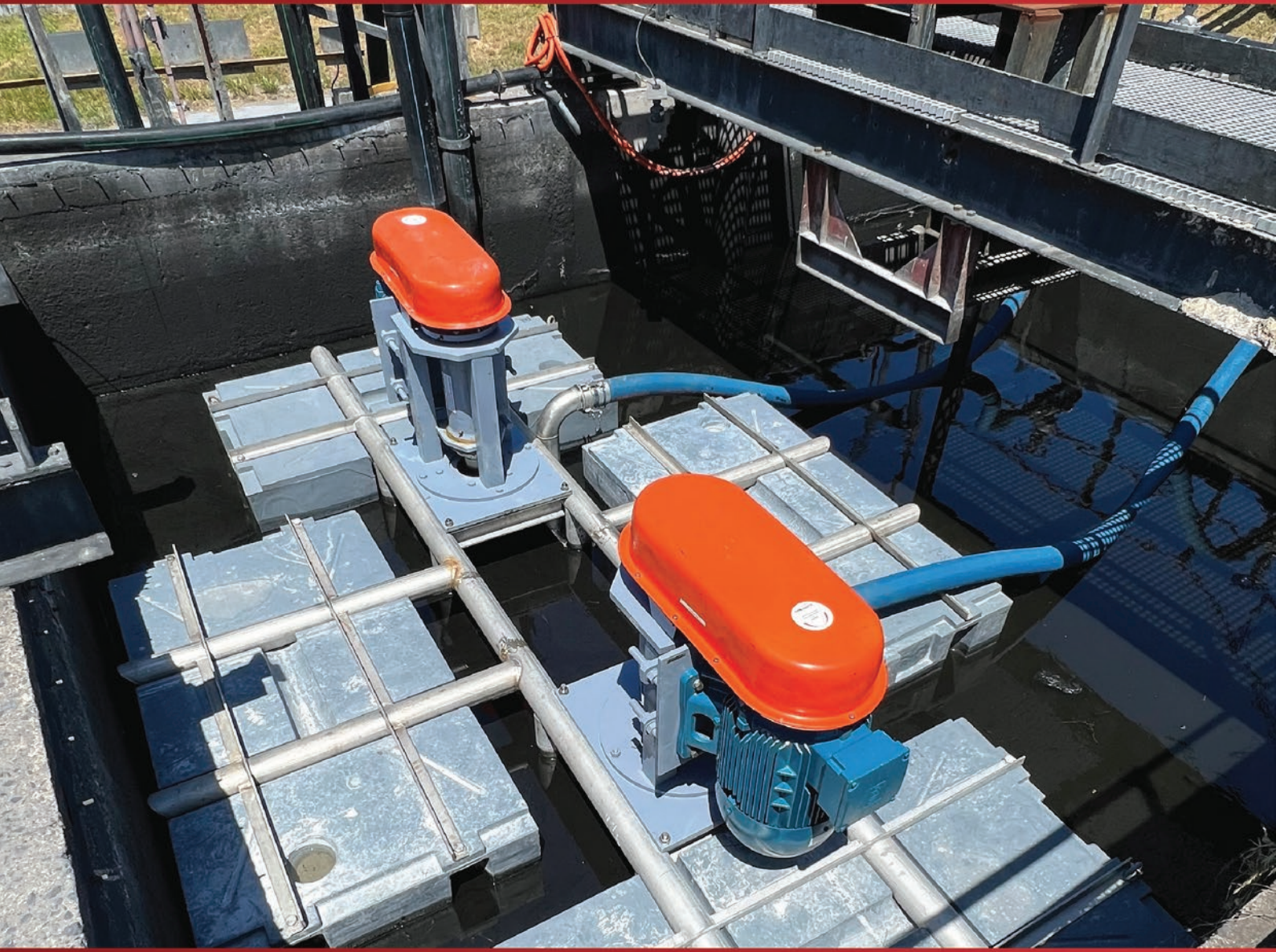

SUMPGUARD VERTICAL PUMPS

The Lakeside Equipment SumpGuard range are vertical cantilever design pumps for use in a wide range of industrial, mining and agricultural applications including slurry dams, sumps, stormwater, sewage, spillage, effluent and production waste.

Cantilever pumps are specialized centrifugal pumps utilizing a cantilever design (Anchored at one end) in which only the column, shaft, impeller, and casing are submerged in the tank or sump. This is typically called the wet end and ensures all electrical components, joint, seals bearings and bushes sit outside of the fluid for better reliability.

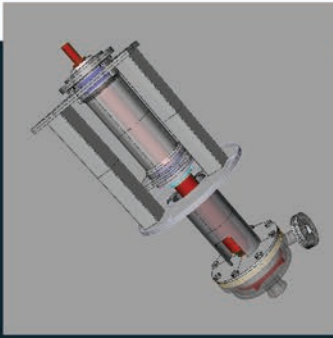

THE RANGE

The range comes complete with 2 different and unique offerings:

- 1. The dedicated Slurry-Busta HM50 with 90m Head Capability ideal for agricultural slurry applications**
 - HM50 – 240mm Semi open impeller/Single Volute 32mm x 32mm discharge
- 2. 4 varied performance options ranging from a 33mm to 150mm discharge and flow rates of up to 300 cubes/hour**
 - V80 – 200mm Impeller/Single Volute/80mm x 80mm discharge
 - V100 – 300mm Impeller/Single Volute/125mm x 100mm discharge
 - V150 – 360mm Impeller/Single Volute/175mm x 150mm discharge

KEY FEATURES

- **Pumps are glandless with run dry capabilities**
- Axial adjustment to take up any wear between impeller and wear plate
- Vortex impeller allows for easy and uninhibited movement of large solids up to 100mm
- Easy Management of fibrous and string matter typical of slurry and effluent
- Discharge orientation can be adjusted at 90° intervals as required for optimum pipeline design
- Variable and customized column length from 600mm to 1800mm
- Rigid shaft design to withstand radial forces
- Dynamically balanced impeller
- Pumps are suitable for in sump or external mounted applications
- Spherical roller bearing and cylindrical roller bearing design for optimal support
- Pumps can be v-belt driven or direct coupled
- Optional turnkey slurry solution complete with raft, float, and agitator

Materials and design:

- **Abrasion resistant High-Chrome Iron**
- Optional 316 Stainless Steel for corrosive fluids

Pump	Impeller	Vanes	Impeller	Max Sphere	Head	Max RPM	Flow rate m3/H
HM50	240mm	4	Semi Open	15mm	90	3000	65
V80	200mm	8	Vortex	33mm	40	2600	110
V100	300mm	8	Vortex	75mm	55	2000	230
V150	360mm	8	Vortex	100mm	45	1500	450

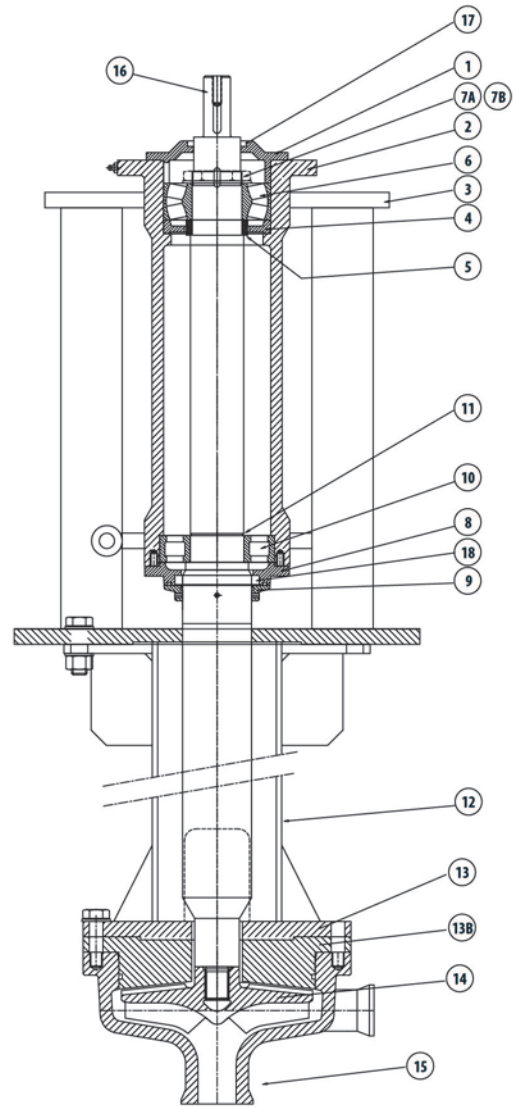
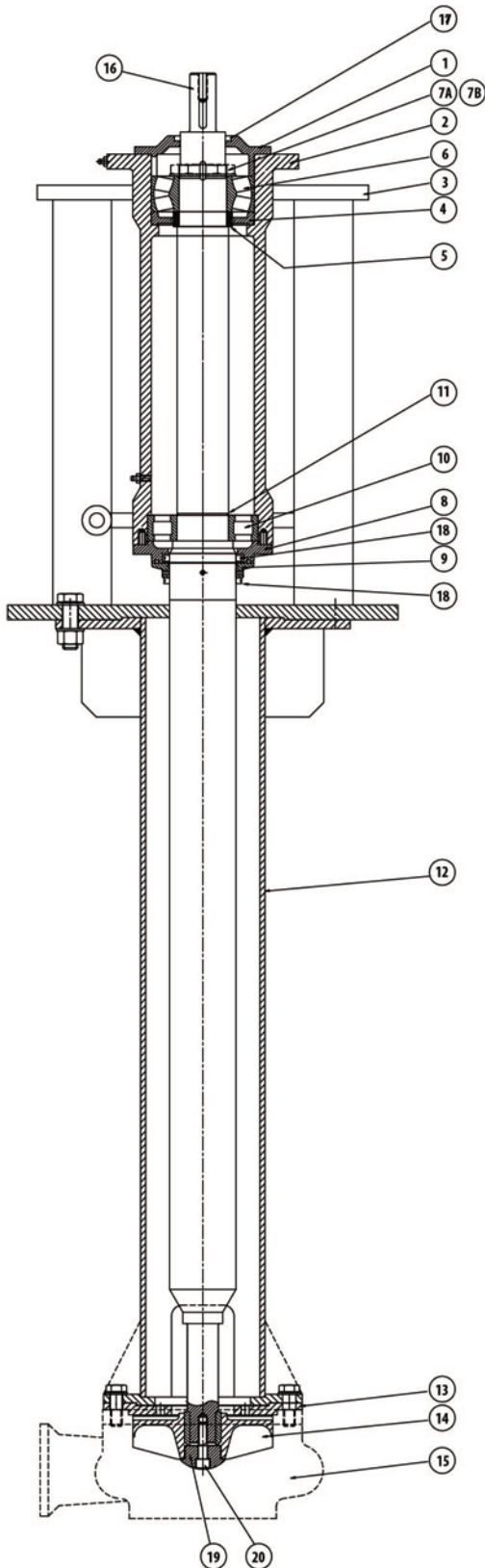

- 1. Cover / Lock
- 2. Bearing Housing
- 3. Top Frame Assembly
- 4. Spacer
- 5. Spacer Ring
- 6. Bearing
- 7A. Nut
- 7B. Washer
- 8. Labyrinth Cover
- 9. Sealing Ring
- 10. Bearing
- 11. Circlip
- 12. Lower Frame Assembly
- 13A. Casing Cover
- 13B. Back Liner
- 14. Impeller
- 15. Volute Casing

Pump HM50
Performance curve

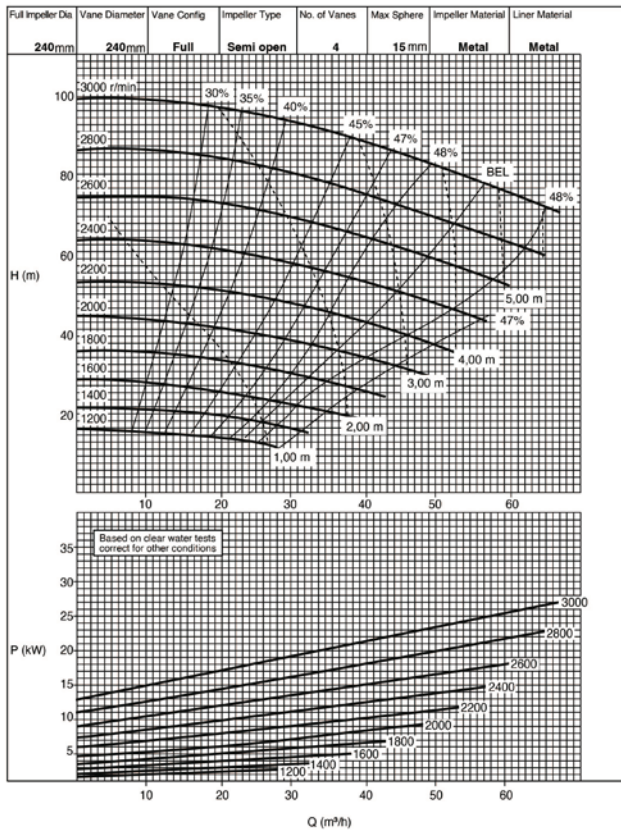

V80
Performance curve

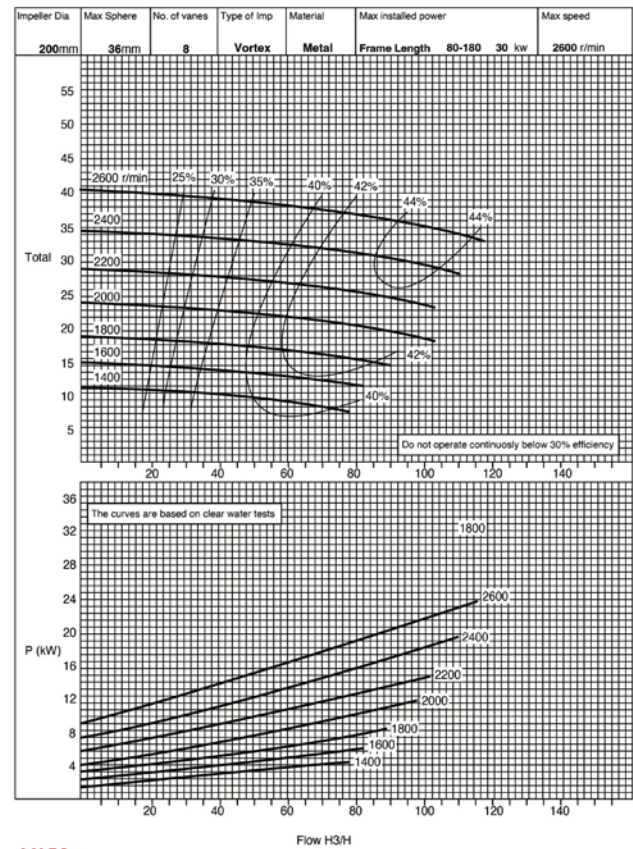

V100
Performance curve

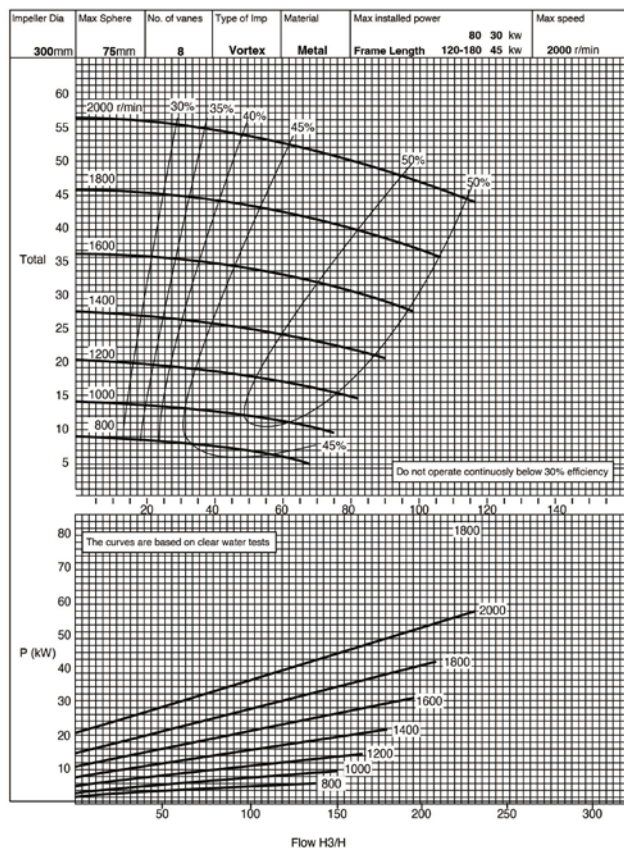

V150
Performance curve

